



LEADING FILTER 核盛过滤 | 引领过滤科技 TECHNOLOGY

青岛核盛智能环保设备有限公司

QINGDAO HESHENG INTELLIGENT ENVIRONMENTAL PROTECTION EQUIPMENT CO., LTD.

烟台核盛过滤机械有限公司

YANTAI HESHENG FILTRATION MACHINERY CO., LTD.

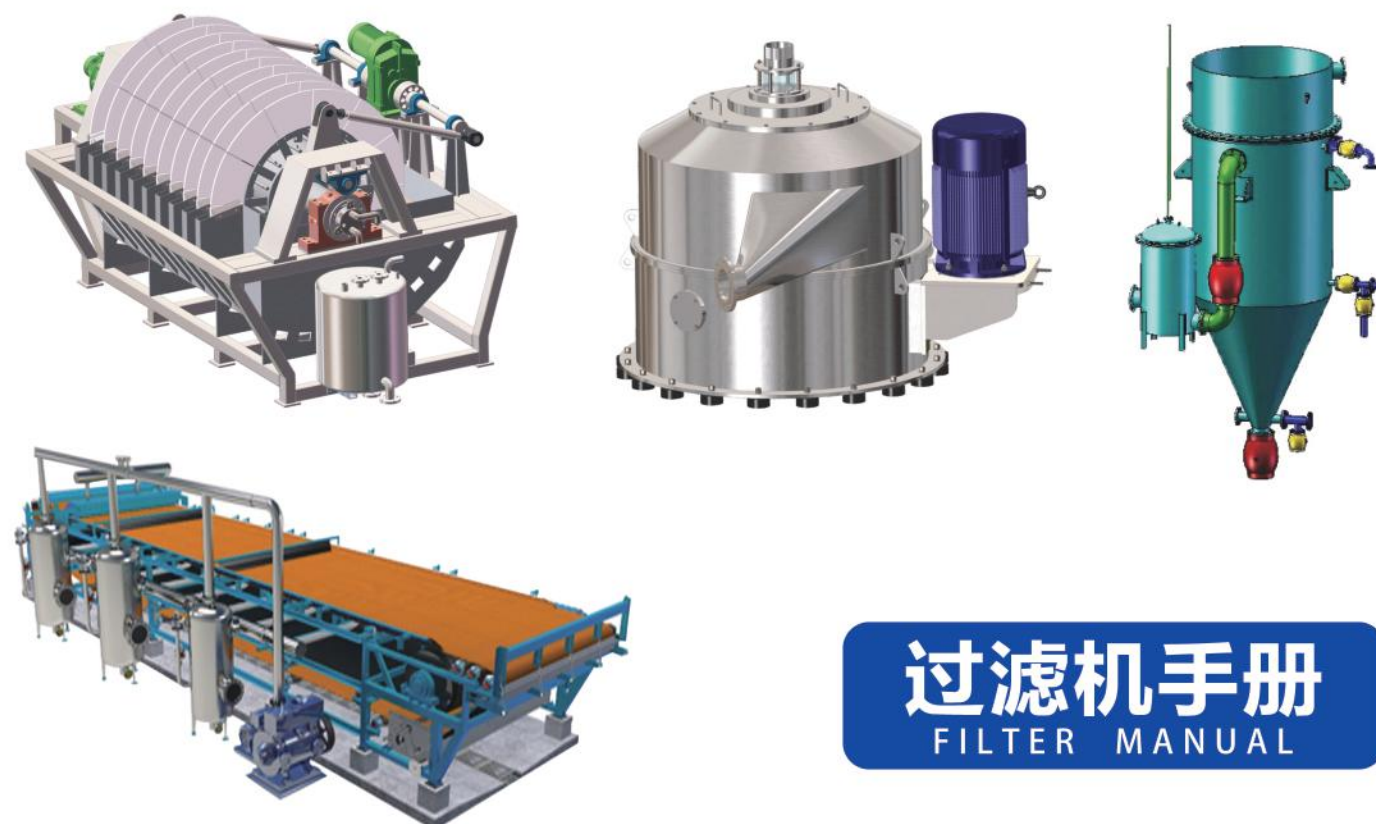

过滤机手册
FILTER MANUAL



青岛核盛智能环保设备有限公司

QINGDAO HESHENG INTELLIGENT ENVIRONMENTAL PROTECTION EQUIPMENT CO., LTD.

山东省青岛莱西市深圳北路255号
NO.255, SHENZHEN NORTH ROAD, LAIXI CITY, QINGDAO CITY, SHANDONG P.R. CHINA.

+86 532 83960966

+86 532 83961788

admin@heshengco.com

[邮编 / P.S CODE] 266600



website



官方网站



COMPANY PROFILE

企业简介

青岛核盛智能环保设备有限公司是专业从事智能过滤设备的生产、研发和销售的高科技企业。公司聚集了中国从事过滤行业的顶尖人才，积累了二十多年的研发、生产、销售和服务经验，拥有先进的智能机加工设备。严格的质量控制、优质的售后服务、超前的创新意识和能力，使公司始终走在过滤行业的技术前沿。

公司的主要产品有：水平带式真空过滤机、陶瓷真空过滤机、叠式压滤机、智能压榨过滤机、水

平带式加压过滤机、加压叠盘过滤机、带式真空震筛过滤机、离心机、管式过滤器等产品。广泛应用于化工、矿山、冶金、化肥、医药、食品、造纸、环保、污水处理、尾矿处理等行业。

公司秉承“为客户创造价值，让员工实现梦想，为社会创造财富”的经营理念，为用户提供高质量的产品和科学的过滤解决方案。

核盛环保，为您创造价值！

Qingdao Hesheng Intelligent Environmental Protection Equipment Co., Ltd. is a high-tech enterprise in production, R & D and sales for intelligent filters. We gathered the top talents in Chinese filtration field, they have more than 20 years' experience in R & D, production, sales and services. We have advanced intelligent machining equipment, the rigorous quality control system and high-class after-sales service system, the advanced innovation consciousness and ability to make us always walk at the forefront of the filter industry.

Our main products as follows: Horizontal Vacuum Belt Filter, Ceramic Disc Filter, Stacked Filter Press, Intelligent Horizontal Press Filter, Horizontal belt press filter, disc press filter, vacuum belt shaking filter, Centrifuge, Disc press filter, Belt vacuum vibrating stage dewatering machine, tubular filter, high efficiency thickener and so on. They are widely used in chemical industry, mining,

metallurgy, fertilizer, medicine, food, paper-making, environmental protection, waste water treatment and tailings dewatering industries.

We adhering to the "Creating value for clients, Realizing dreams for employees, Creating wealth for society" business philosophy, to provide high-quality equipment and scientific filtration proposal for users.

Hesheng Environmental Protection, Creat Value for You.

COHESION
VIRTUE 厚德 聚力
创新 共赢
WIN-WIN
INNOVATION

ENTERPRISE CULTURE

企业文化

核心价值观 / CORE VALUE

厚德，聚力，创新，共赢。
VIRTUE, COHESION, INNOVATION, WIN-WIN.

企业精神 / ENTERPRISE SPIRIT

仁爱，坚韧，诚信，担当。
Benevolence, Tenacity, Honesty, Responsibility.

经营理念 / BUSINESS PHILOSOPHY

为客户创造价值，为员工实现梦想，为社会创造财富。
Creating Value for Clients, Realizing Dreams for Employees,
Creating Wealth for Society.

企业使命 / ENTERPRISE MISSION

使过滤器更加智能高效，让核盛过滤走向世界。
To Make the Filter More Intelligent and Efficient, to
Make Hesheng Brand Filter to All Over the World.

管理理念 / MANAGEMENT PHILOSOPHY

尊重融合，开放包容，科学决策，高效务实。
Respect Integration, Openness and Inclusiveness, Scientific Decision-making,
Efficiency and Pragmatism.

质量方针 / QUALITY POLICY

精益求精，用户满意，持续改进，追求卓越。
Make Perfection More Perfect, Customer Satisfaction, Continuous Improvement,
Pursuit of Excellence.

核心竞争力 / CORE COMPETITIVENESS

团队协作，持续创新。
Team Work, Continuous Innovation.

企业愿景 / ENTERPRISE VISION

员工幸福，团队一流，科技领先，全球品牌。
Happy Employees, First-class Team, Leading Technology, Global Brand.

ENTERPRISE QUALIFICATION

企业资质



CE证书



CE证书



CE证书



安全生产标准化



知识产权管理体系
认证证书



计算机软件著作权



计算机软件著作权



职业健康安全管理体系
认证证书



环境管理体系
认证证书



质量管理体系
认证证书



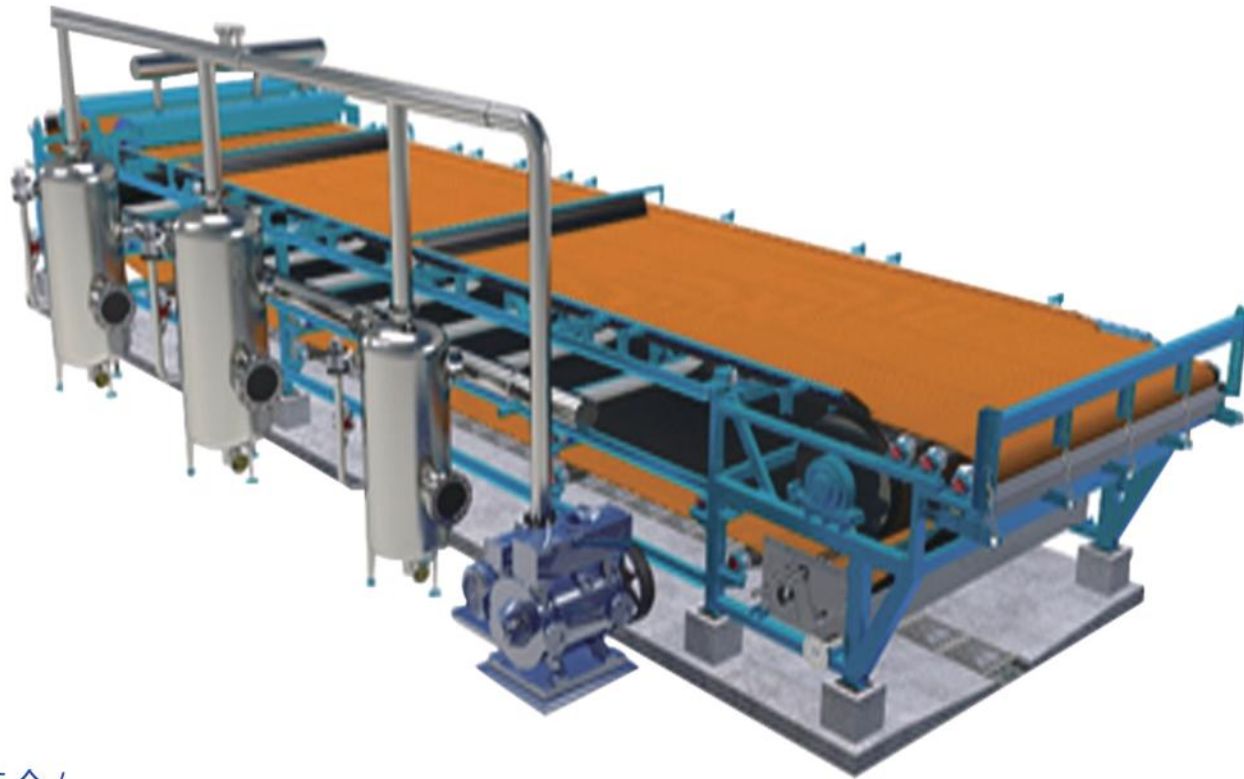

简介/ Brief introduction

水平真空过滤机是以滤布为过滤介质，充分利用物料重力和真空吸力实现固液分离的高效固液分离设备。

The Horizontal Vacuum Belt Filter use filtering fabric as the filter medium, which utilizes the material gravity and vacuum suction to realize the separation of the solid and liquid.

工作原理/ Operating Principle

该设备采用了固定真空盒，环形胶带由减速机拖动在真空盒上连续运行，滤布铺敷在胶带上与之同步运行，胶带与真空盒滑台上的摩擦带接触并形成水密封的结构。料浆由下料斗，均匀地布在滤布上。当真空室接通真空系统时，在胶带上形成真空抽滤区，滤液穿过滤布经胶带上的横沟槽汇总并由小孔进入真空室，固体颗粒被截留在滤布上形成滤饼。进入真空室的液体经排液罐排出，随着橡胶带的移动，已形成滤饼依次进入滤饼洗涤区和洗干区，最后滤布与胶带分开，在卸料辊处将滤饼卸出（进入卸料区）。卸除滤饼的滤布经清洗后获得再生，再经过一组支承辊和纠偏装置后重新进入过滤区，然后再进入下一个过滤周期。



This equipment adopts the fixed vacuum chamber, the rubber belt is driven by the gearbox and running continuously on the vacuum chamber, the cloth moving synchronously on the rubber belt. The friction belt on the slipway of vacuum chamber forming a water sealing structure with rubber belt. The slurry feeding on the cloth smoothly and evenly by feeding hopper. When the vacuum chamber connects with vacuum system, the filtering area with vacuum suction will be formed on the rubber belt, the filtrate passes through the cloth and flows to the grooves and holes of rubber belt to vacuum chamber, the solids form a cake on the surface of cloth. The filtrate in the vacuum chamber is discharged by the vacuum tank. Moving by the rubber belt, the cake moves to the cake washing area and drying area sequentially, then enters the cake discharging area. After discharging the cake, the cloth is washed by the washing system and enters the next filtering cycle.

特点/ Features

- ◆ 在结构上实现了模块化设计，组装灵活，运输方便。也可安装调试完毕后，再整体吊装运输。
- ◆ 在过滤上实现了滤布与胶带同步运行，能够连续完成进料、抽滤、洗涤、干燥、滤布再生等功能。
- ◆ 在控制上实现了远程与现场交互控制的方式，便于实施无人操作。
- ◆ 在胶带支承上实现了托辊式、气垫式、托盘式、多条摩擦带支撑等多种方式，减少摩擦阻力，增加了胶带寿命。
- ◆ 在洗涤上实现了可分段收集，并可顺流或逆流洗涤。
- ◆ 在滤布再生上可选配高压清洗方式增加滤布的再生效果及寿命。
- ◆ 在排液方式上有零位排液、高位排液、辅助排液。
- ◆ 在设备外形上增加了气罩或铝塑窗实现了半封闭或全封闭，用于含有挥发性气体或蒸汽的物料局部保温或集中收集。
- ◆ Modular design, flexible assembly and convenient transportation are implemented for structure. It also can deliver the whole assembled equipment after installation and commissioning.
- ◆ The filter cloth and rubber belt operating synchronously is applied to the filter, which can be finished the process of continuous feeding, filtering, washing, drying and cloth washing.
- ◆ The remote control and local control can be exchanged to achieve unmanned operations.
- ◆ On the rubber belt support, we can use rollers, air cushion, pallet and multiple friction belts to reduce the friction resistance and prolong the rubber belt life time.
- ◆ Use filtrate or clean water for the cake washing and collect the filtrate by sections.
- ◆ Use high pressure water for cloth washing to increase the cloth regenerative effect and the life span.
- ◆ Filtrate discharge types include automatic discharge, high level discharge and auxiliary discharge.
- ◆ Gas cover or aluminum plastic Windows can be designed partial closed or totally enclosed for partial insulation or the centralized collection for the volatile gas or steam of slurry.

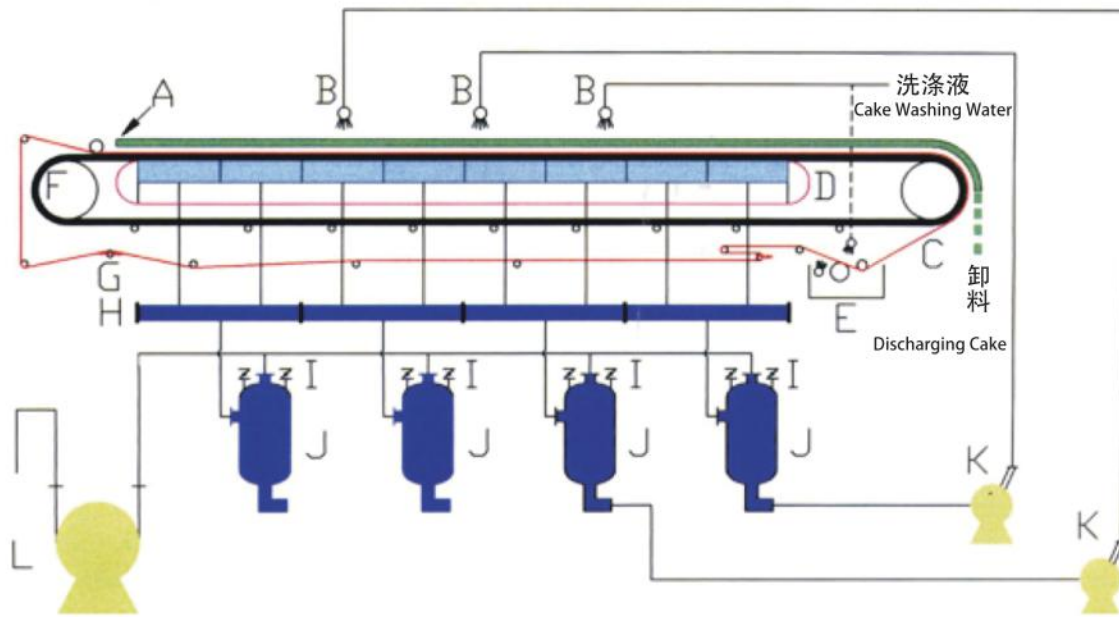
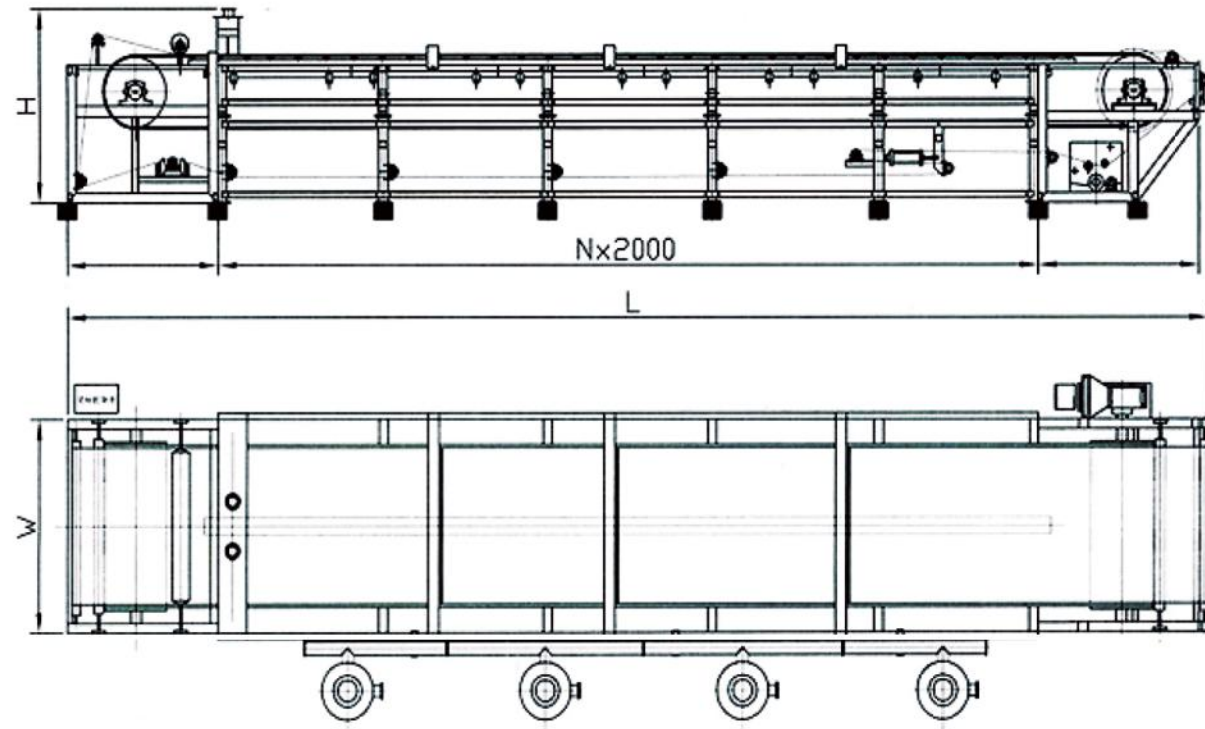

- A 加料装置 slurry feeding
- B 洗涤装置 cake washing
- C 滤布 cloth
- D 摩擦带 friction belt
- E 清洗装置 cloth washing device
- F 橡胶带 rubber belt
- G 纠偏装置 cloth redirection device
- H 滤液装置(滤液总管/真空总管) main vacuum pipe
- I 切换阀 exchange valve
- J 排液分离器(排液罐/真空罐) vacuum tank
- K 洗涤泵 water pump for cake washing
- L 真空泵 vacuum pump

过滤面积 Filtrating area	有效宽度 effective width	有效长度 effective length	整机总长 Frame length	机架宽度 Frame width	机身高度 Frame height	重量 weight	真空耗量 Vacuum consumption m ³ /min
2	500	4000	8100	1100	2070	5.5	8
3		6000	10100			6	12
4		8000	12100			6.5	16
5		10000	14100			7	18
6		12000	16100			7.6	22
8	1000	8000	12100	1600	2070	8.8	25
10		10000	14100			9.6	28
12		12000	16100			10.4	30
14		14000	18100			11.1	33
10.4	1300	8000	12100	1900	2170	9.8	28
13		10000	14100			10.8	30
15.6		12000	16100			11.5	35
18.2		14000	18100			13.2	38
20.8		16000	20100			15.1	42
20	2000	10000	14100	2700	2170	14.2	40
24		12000	16100			17.8	48
28		14000	18100			20.2	52
32		16000	20100			23.6	65
20	2500	8000	12100	3200	2270	14.8	40
25		10000	14100			18.6	50
30		12000	16100			22.2	60
35		14000	18100			26	70
40		16000	20100			29.8	80
50		20000	24100			41	95
30	3000	10000	14100	3750	2270	22.8	60
36		12000	16100			27.5	72
42		14000	18100			32.5	85
54		18000	22100			45	105
60		20000	24100			50.5	120
48	4000	12000	16100	4800	2470	39.5	92
56		14000	18100			46.8	110
64		16000	20100			52.6	120
72		18000	22100			58.3	145
80		20000	24100			63	160
144	4500	32500	41200	7100	5500	70	360

也可根据现场和物料情况设计机型。

目前已广泛应用于冶金、矿山、石化、化工、洗煤、造纸、肥料、食品、制药、环保等领域中的固液分离，烟气脱硫中的石膏脱水、尾矿处理等行业。

The machine also can according to the local plant and material situation to be designed.

The belt filter is widely used in solid-liquid separation of metallurgy, mining, petrochemical, chemical, coal washing, paper making, fertilizers, food, pharmaceutical, environmental protection, also the gypsum dehydration of flue gas desulfurization, tailing dewatering and other fields. centralized collection for the volatile gas or steam of slurry.

MAIN PART PICTURE

主要部件图



橡胶过滤带/Rubber Belt



辊子/Rollers

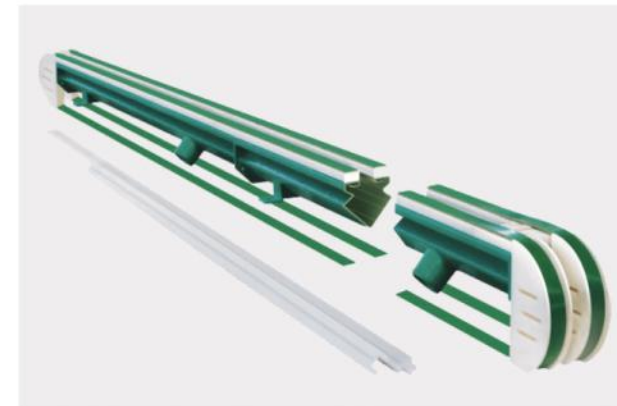

真空盒系统/Vacuum Chamber System

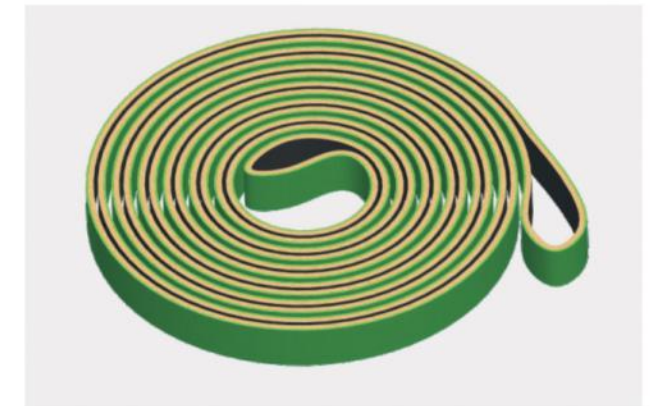

摩擦带/Friction Belt



驱动辊/Drive Roller

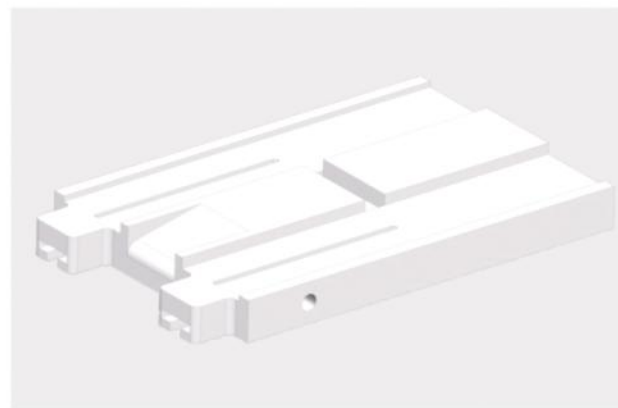

滑台/Slipway



气囊纠编/Gasbag For Rectify

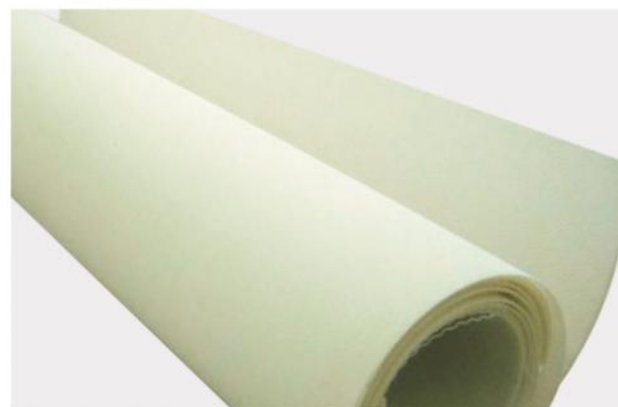

滤布/Filter Cloth

WELDING PHOTO

焊接精度图



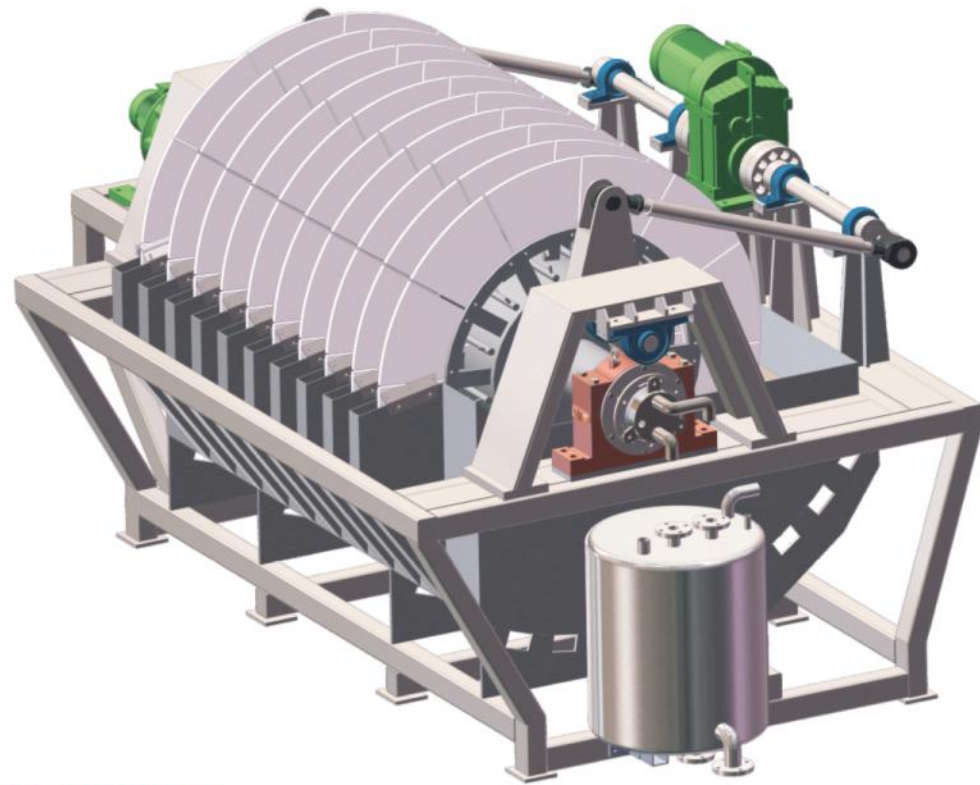

简介/ Brief introduction

陶瓷过滤机是一种依靠真空负压和陶瓷过滤板的毛细作用实现固液分离的设备。抽取陶瓷板内腔空气使之与外部产生压差，料浆槽内悬浮的固体物料在负压的作用下吸附在陶瓷板上，而液体因真空压差的作用以及陶瓷板的亲水性通过陶瓷板的表层进入陶瓷板内腔，这样就达到了固液分离的目的。

The ceramic disc filter is a kind of equipment which use the vacuum negative pressure and the capillarity of ceramic plate to realize solid-liquid separation.

Extract air inside of the ceramic plate to make the pressure difference with external, under the negative pressure, the solids in the slurry tank will be absorbed on the ceramic plate surface. And the filtrate will be flow from the outside to inside of ceramic plate with negative pressure difference and the hydrophilicity of ceramic plate, so that to reach the purpose of the solid-liquid separation.

工作原理/ Operating Principle

浸没在料浆槽的滤板在真空负压的作用下，通过滤板毛细孔吸附，表面形成物料滤饼层；滤液从滤板内部通过管道到达排液罐后排出。

转子带动滤板和吸附在滤板上的滤饼转到干燥区，在真空的作用下滤饼继续脱水。滤饼干燥后，转子转动到卸料区（无真空），通过陶瓷刮刀卸料。

卸料后的陶瓷板进入反冲洗区，工业水或压缩空气经过反冲洗管进入陶瓷板内腔，由内而外清洗陶瓷板内孔。

陶瓷板工作一段时间后，采用超声波配合低浓度酸的联合清洗，保证陶瓷板的高效使用。

The ceramic plate immersed in the slurry tank, and the material cake layer formed on its surface under vacuum negative pressure and adsorbed by the plate capillary. The liquid passes through the inside of the plate and pipes to the vacuum tank and discharge out. Difference and the hydrophilicity of ceramic plate, so that to reach the purpose of the solid-liquid separation.

The cake on the plates running by main roller to drying area, and continues to dehydrate under vacuum function. Then running to cake discharging area (without vacuum) to discharge the cake by ceramic scraper.

After discharging, the ceramic plate running to the back washing area, the process water or compressed air will be enters to the ceramic plate inside by the back washing pipes, and washing the ceramic plate holes from inside to outside.

After working for one shift, the ceramic plate should be washed by ultrasonic waves and combined with low concentration acid to ensure its efficiency.

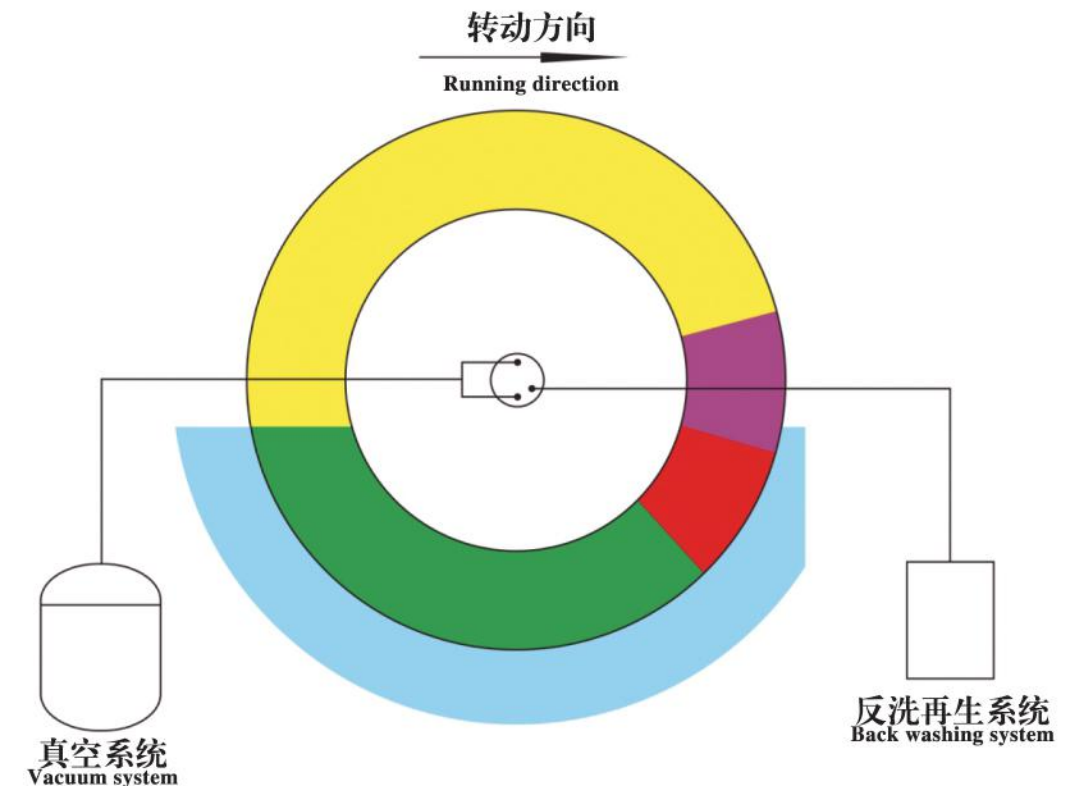
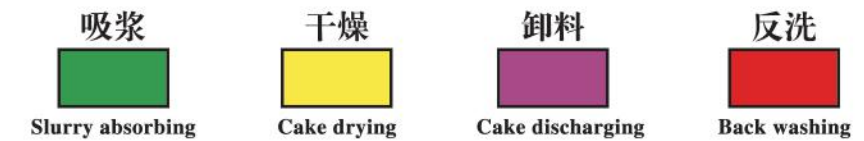

特点/ Features

能耗低，运行成本低（真空损耗小），滤饼水分低，过滤液含固量低，可直接排放回反复利用。自动化程度高，结构紧凑，占地小，安装维护方便。

Low power consumption, low operation cost (low vacuum loss), low cake moisture, low solids content in filtrate and can be reused. High automation, compact structure, small space occupied, and easy installation and maintenance. With negative pressure difference and the hydrophilicity of ceramic plate, so that to reach the purpose of the solid-liquid separation.

型号面积 (model & area m ²)	滤盘/圈 (filter disc /cycle)	滤板数量/块 (plate Qty. /Pcs)	装机功率 /KWInstalled Power /KW	运行功率 /KWOperating power/KW	主机 Main body (L×W×H) /M
CF-1	1	12	3.5	2	1.6×1.4×1.5
CF-6	2	24	7	6	2.4×2.9×2.5
CF-15	5	60	11.5	8	3.3×3.0×2.5
CF-30	10	120	17.5	11.5	5.5×3.0×2.6
CF-48	12	144	34	24	5.7×3.1×3.0
CF-60	12	144	45	33	6.0×3.3×3.1
CF-80	16	192	63	47	7.3×3.3×3.1
CF-120	20	240	77	57	8.5×3.7×3.3
CF-144	12	144	110	89	8.0×4.9×4.7

陶机主要配件/ Main Spare Parts

箍断阀 陶瓷分配头 陶瓷板 超声波阵子盒 超声波电源 刮刀

Pinch-off Valve, Ceramic Distributed Valve, Ceramic Plate, Ultrasonic Generator, Ultrasonic Power Supply, Ceramic Scraper



陶瓷过滤板
Ceramic Plate

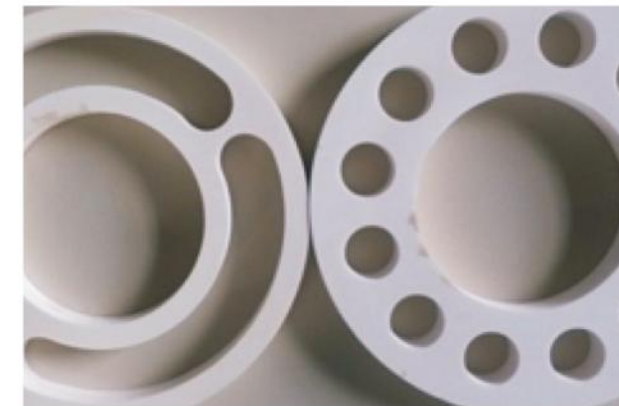

分配阀
Distributed Valve



箍断阀
Pinch-off Valve



超声波电源
Ultrasonic Generator



固定式振子盒
Fixed Ultrasonic Cleaning Box



自动升降式振子盒
Automatic lifting Ultrasonic Cleaning Box



目前已广泛应用于矿山、黑色金属、有色金属、稀有金属、非金属等精矿及尾矿脱水，及环保污水污泥废酸处理等。

Currently has been widely used in mining, ferrous metals, non-ferrous metals, rare metals, non-metallic ore concentrate and tailings dehydration, and environmental protection sewage sludge waste acid treatment, etc.

DL系列自动连续导流离心机



简介/ Brief introduction

DL 系列自动连续导流离心机是一种固液分离设备，该机采用立式结构，实现了连续、自动、封闭的工作方式，有效的解决了在实际生产中遇到的问题，可以一人多机操作。对颗粒粒径在80 μm以上、固含在于15%–65%之间的混合液可以实现有效的分离，满足生产的需要。在化工、医药等行业运用广泛。

DL Automatic continuous diversion centrifuge is a kind of solid-liquid separate equipment, which use vertical structure to reach continuous, automatic, and sealing operation. It can effectively solve the problems in real using conditions, reach one operate multimachines performance. Effectively separate the mixed liquor with the solid size bigger than 80um and solidity between 15% to 65% to reach the client requirement. This centrifuge widely used in chemical industry, pharmaceuticals industry and so on.

主要结构/ Main Structure

DL 系列自动连续导流离心机主要机构由可调导流分离装置、传动装置、滤液收集仓、固体收集仓、减震结构、电机等主要部件组成，设备易损件少，运行稳定。

Main structure of DL Automatic continuous diversion centrifuge including adjustable diversion separator device, drive device, filtrate collector, solid collector, absorb shock structure, motor. It has a few wearing parts and working stable.

DL系列自动连续导流离心机

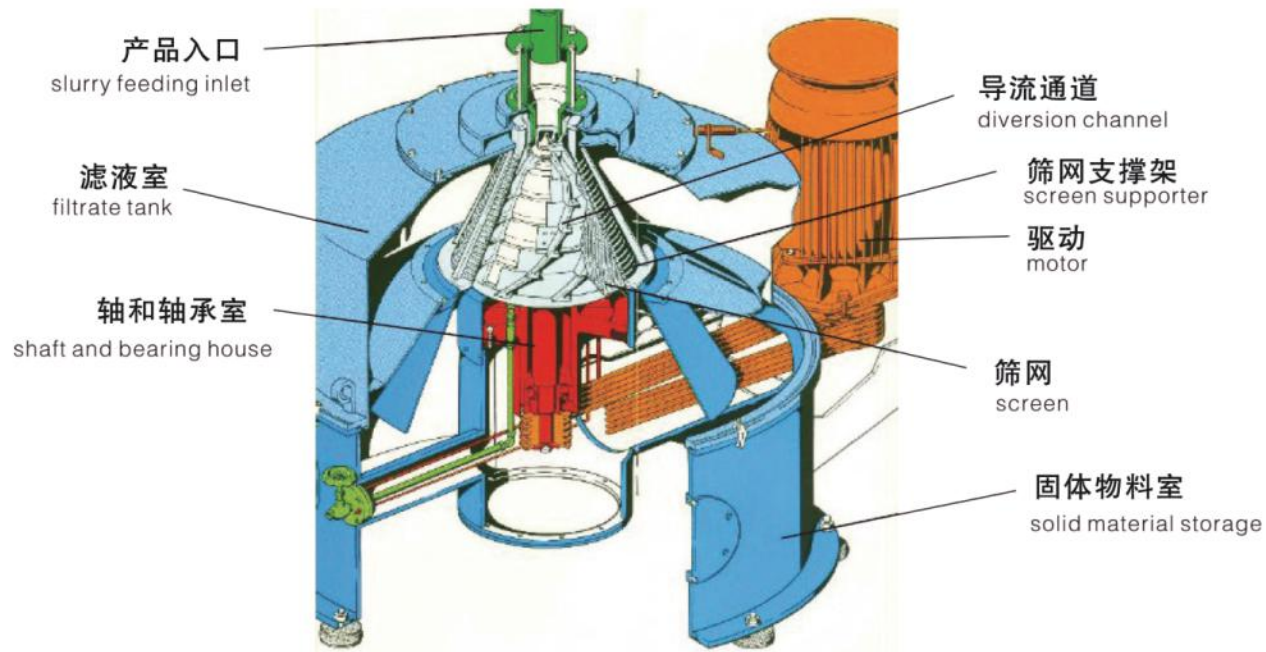

可调导流分离装置由内转鼓、可调导流结构、滤网、外部滤网支撑组成。
 Adjustable diversion separator device made up of inner drum, adjustable diversion structure, screen and outside screen supporter.



运行原理/ Working Principle

设备操作时，滤网、滤网支承和可调导流结构按设定转速运转，达到预定转速后，物料从进料口匀速输入。物料进入分离装置后，其中的固体被滤网截留住，在重力和离心力作用下，自动下卸，进入固体收集仓，而滤液则穿过滤网和外部滤网支撑进入滤液收集仓，然后通过出液口排出。

During the equipment operation, screen, screen supporter and adjustable diversion structure are running by setting speed, when the speed up to setting value, the slurry feeding from inlet constantly. After the slurry feeding to separator, the solids were hold on the screen, and discharge automatically by its gravity and centrifugal force to solid material storage. The filtrate will pass through screen and outside screen supporter to filtrate collector and discharge liquid through outlet.

DL系列自动连续导流离心机

技术参数/ Technical Data List

型号 Model	转鼓最大直径 Max. dia. of drum (mm)	最高转速 Max. speed (r/min)	分离因数 Separation factor	功率 Power (KW)	理论处理量 Theoretical capacity (m ³ /h)	重量 Weight (kg)
DL400	372	3282	2226	15	3	800
DL500	443	2920	2127	22	5-6	1200
DL600	546	2660	2146	30	7-8	1600

部分运用范围/ Part Application Scope

PPS (聚苯硫醚) 硫酸铜 工业盐 食用盐 酒石酸 柠檬酸 富马酸
氯化钾 硫酸铵 碳酸氢铵 木糖醇 ABS脂 聚乙烯 硫酸镍 PVC
(对颗粒粒径在80 μm以上、固含在于15%–65%之间的混合液可以实现有效的分离)
PPS (polyphenylene sulfide), copper sulfate, industrial salt, edible salt, tartaric acid, citric acid, fumaric acid, potassium chloride, ammonium sulfate, ammonium bicarbonate, xylitol, ABS, polyethylene, nickel sulfate, PVC
Effectively separate the mixed liquor with the solid size bigger than 80um and solidity between 15% to 65%

主要特点/ Main Features

- ◆ 自动、连续，有效的提高设备在整个生产工艺流程连贯性，降低操作强度
 - ◆ 较好的稳定性，易损件少，故障率低
 - ◆ 基础简单，无需复杂的减震平台
 - ◆ 整机封闭，对有异味的物料可以有效的封闭，形成环保、清洁的工作环境
 - ◆ 极高的平稳性、在运行过程中平稳、无明显的振动现象
 - ◆ 变频调速，根据不同的分离效果选择合适的运行转数
- * Automatic, continuous, it is effective improve the equipment consistency and reduce operating strength in the whole process.
- * Good stability, a few wearing parts, low fault rate
- * Simple foundation, no complicated absorb shock platform.
- * Whole machine sealing, so as to close the smelly material, and form a clean and environment protection working site.
- * High stability, working stable, no obviously shaking.
- * Frequency control speed, according to different separating efficiency to choose right speed.



简介/ Equipment Introduction

*** PGT 系列精密微孔过滤机**

PGT 系列精密微孔过滤机采用PE、PA过滤管作为过滤介质，对于固含较低，温度在0-90℃之间的物料处理，能达到良好的效果。一机实现二次进料、滤饼风干、滤液无残留、全自动化控制的功能。

*** TGT 系列陶瓷微孔过滤机**

TGT 系列陶瓷微孔过滤机采用陶瓷膜过滤管作为过滤介质，对于高温环境物料有广泛的适用。

*** BGT 系列不锈钢管微孔过滤机**

BGT 系列不锈钢管微孔过滤机采用不锈钢纤维烧结过滤管作为过滤介质，具有适用温度广、大通量的特点，在煤化工行业运用广泛。

*** FGT 系列管式薄膜过滤机**

FGT 系列管式薄膜过滤机是采用有机膜或滤布袋作为过滤介质，对悬浮物处理效果良好。

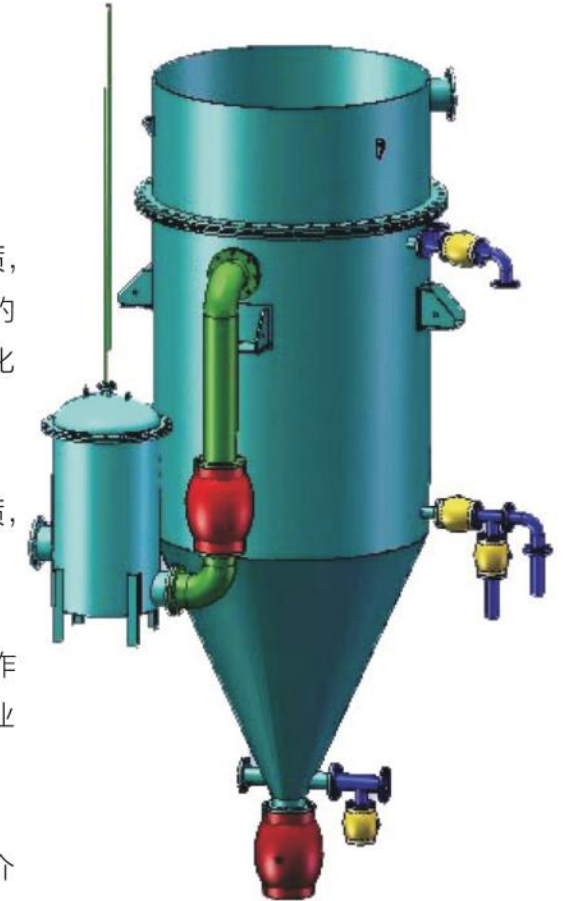

PGT series precise microporous tube filter

PGT series precise microporous tube filter use PE, PA filter tube as filter medium, it is suit for filtering low solidity and temperature between 0-90℃ material, which can reach a good result. This filter can reach second time slurry feeding, cake drying, no remains of filtrate, full-automatic control function.

TGT series ceramic microporous tube filter

TGT series ceramic microporous tube filter use ceramic membrane filter tube as filter medium, it is widely used in high temperature slurry field.

BGT series stainless steel microporous tube filter

BGT series stainless steel microporous tube filter use stainless steel fiber sintered filter tube as filter medium, it is widely used in wide temperature range, big volume slurry and coal chemical industry.

FGT series tube film filter

FGT series tube film filter use organic membrane or filter bag as filter medium, it is good at filtering suspended solids.

流程示意图

Flow chart

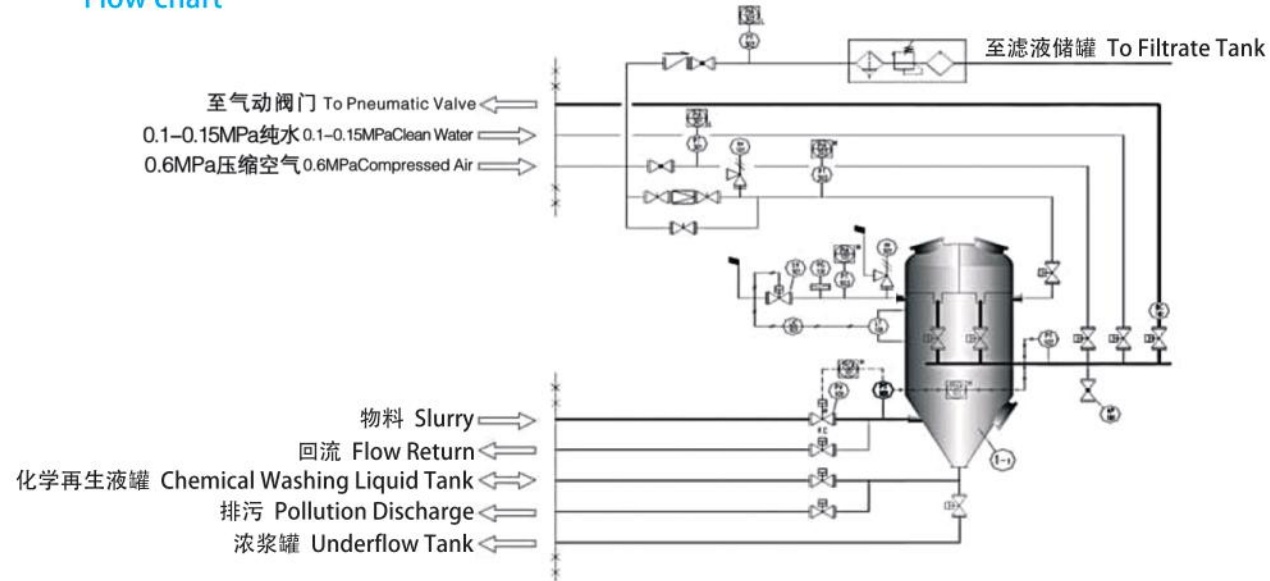

排渣示意图

Discharging Chart

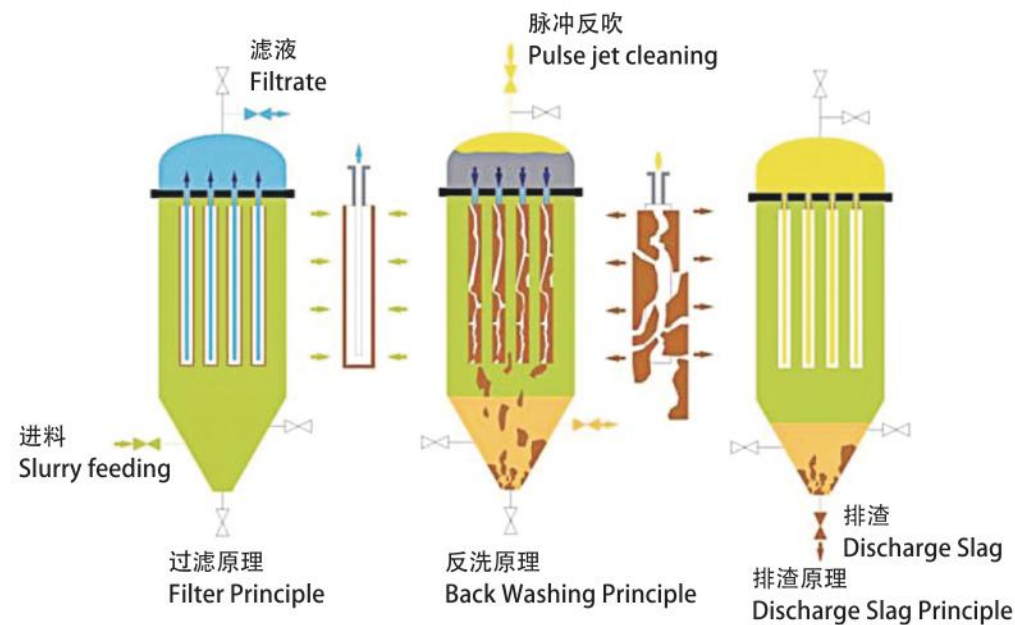

主导产品/ Main Product

- * PGT系列精密微孔过滤机
- * TGT系列陶瓷微孔过滤机
- * BGT系列不锈钢管微孔过滤机
- * FGT系列管式薄膜过滤机

产品应用广泛，遍布化工、湿法冶炼、制药、饮料、食用油、化肥及环保等多个行业。

- PGT series precise microporous tube filter
- TGT series ceramic microporous tube filter
- BGT series stainless steel microporous tube filter
- FGT series tube film filter

The equipment widely used in chemical industry, hydrometallurgy industry, pharmacy, beverage industry, edible oil, fertilizer industry and other environment protection industries.



特点/ Features

- ◇ 节能，能耗极低
- ◇ 密闭操作，现场环境干净，无气味外泄
- ◇ 耐绝大部份的有机溶剂、酸、碱、盐
- ◇ 自动化操作，劳动强度极低，单人可操作多台
- ◇ 过滤精度高，一次滤清，不需要循环
- ◇ 母液回收率高
- ◇ 对悬浮物处理效果良好
- ◇ 设备大小、材质量身定做

- * High efficiency and energy saving
- * Hermetically sealed operation, make local site clean, no smell leakage.
- * Many organic solvent proof, acid proof, alkali proof, salt proof.
- * Automatic operation, low labor strength, one worker can operate serval sets equipment at the same time.
- * High filter precision, one time filtering, no need recycle
- * High recovery of mother liquor
- * Good filtering efficiency for suspended solid
- * According to the real volume to design the equipment size and choose the material.



PE、PA滤芯
Filter element



陶瓷滤芯
Ceramic filter element



薄膜滤袋
Film filter bag



不锈钢滤芯
Stainless steel filter element

- ◇过滤原材料提供方是根据我公司制造过滤管的生产工艺单独特殊配方提供，不同于市场上其它厂家的生产的原材料，从而确保过滤管材质的优质品质；
- ◇过滤管生产工艺的特殊性；
- ◇每根过滤管的毛细孔隙率都能均布，通透性良好，水流性平衡，不会造成同容积中流动的阻力不同，处理能力不同；
- ◇过滤管的过滤精度均匀，从管口到管尾精度一致，不会出现一根管子上下有不同的过滤精度。

The filter medium supplier base on our productive technology of filter tube to supply the special material medium to us, it is different from other suppliers' raw material, so as to ensure the high quality of filter tube. Specificity of filter tube productive technology.

The capillary porosity of each filter tube are uniform distribution, good permeability and good water flow balance, avoiding different flow resistance in the same volume and different filtering capacity.

Filter tube with uniform filter precision, from tube beginning to ends are the same, will not appear different filter precision on the same tube.



PGT系列精密微孔过滤机
PGT series precise microporous tube filter



BG系列不锈钢管微孔过滤机
BGT series stainless steel microporous tube filter



TGT系列陶瓷微孔过滤机
TGT series ceramic microporous tube filter